

Visitors must check-in at the Customer Service Center to obtain a VISITOR's Pass.



Guard House
Rear Entrance from additional Visitors Parking

Additional Parking

- Conference Room
- Fire Exit
- Restrooms

NOTE: Not To Scale
September 29, 2006 (lg)

**DENR
Customer
Service**

Westinghouse Blvd.

Westinghouse Blvd.

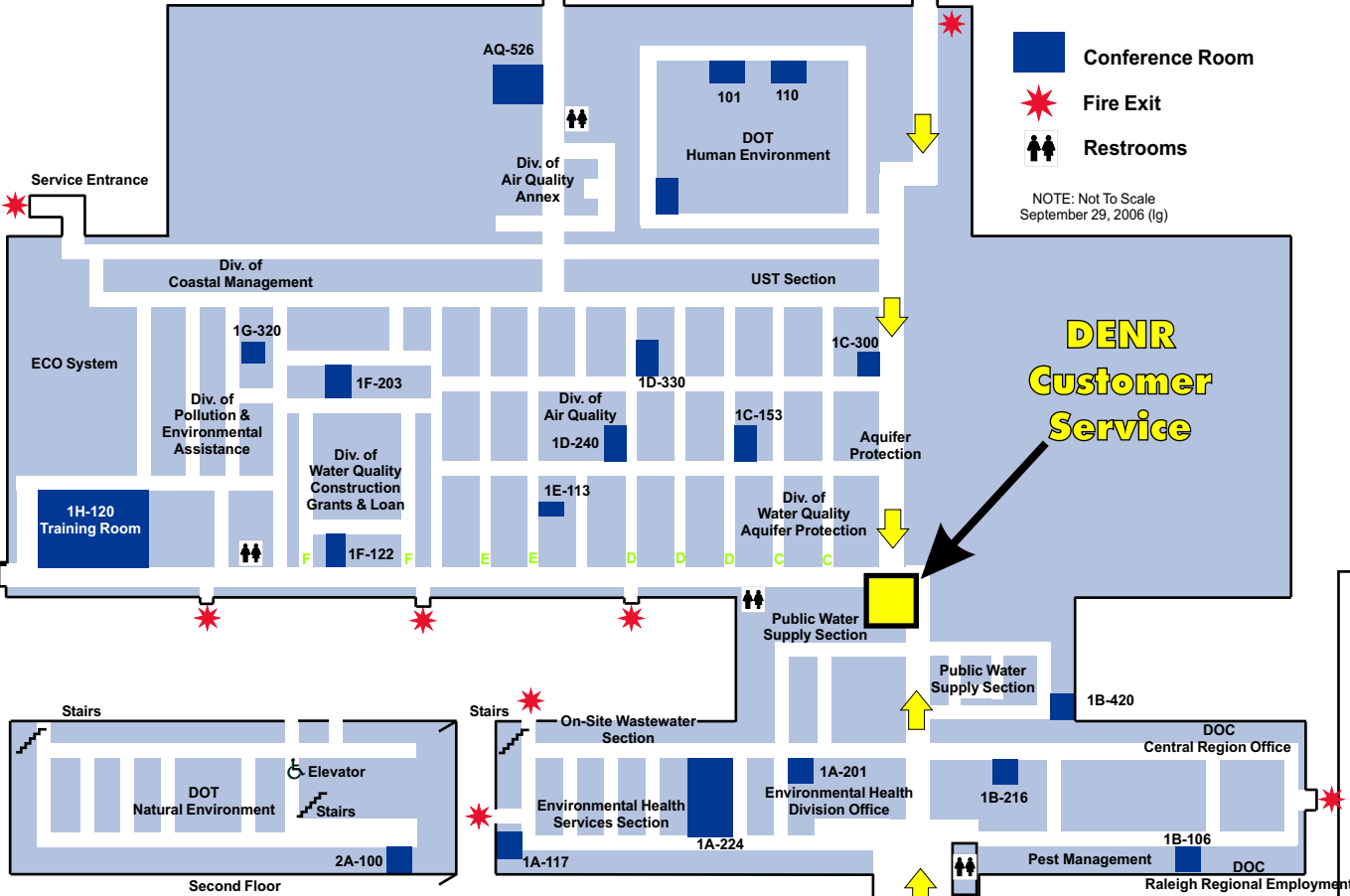

**2728 Capital
Raleigh, NC 27604**

Main Entrance
Visitor Parking

Additional Parking located in the rear of the building

Westinghouse Blvd.

North

Capital Blvd.

Downtown